

TECHNIK™

PROJECTS

REHOMING • VETERINARY HOSPITALS • BOARDING

TECHNIK™ PROJECTS

TECHNIK was founded over 20 years ago as a manufacturer of stainless steel hygienic equipment for the veterinary sector. Over the years we became recognised as a company with design and development expertise. This recognition led to TECHNIK becoming a leader for animal welfare housing.

Manufacturing in stainless steel and aluminium from Broseley, Shropshire, all of our projects are designed and manufactured in house. The 11,500 square metre factory is fitted with state of the art equipment, backed up by skilled manufacturing teams.

TECHNIK Projects install throughout the UK, Europe and Worldwide. There are no constraints to the scale or size of projects. We are equally at home with prestigious full installations, as we are smaller scale veterinary suite refurbishments. All projects receive our diligence and expertise.

Alongside capital expenditure projects TECHNIK is also a supplier of dog kennels, cat kennels, medical lighting, operating tables, examination tables, practice furniture, changing room furniture, dental equipment, stainless steel sinks and hydrotherapy treadmills to name a few.

British manufacturing from the heartland of the industrial revolution

Thomas Farnolls Pritchard's Iron Bridge, Shropshire. Birthplace of the Industrial Revolution.





Battersea Dogs & Cats Home

Battersea Dogs & Cats Home holds an average of 260 dogs and 220 cats at any given time until a new home can be found. TECHNIK and Battersea have worked together for 10 years. This advanced cat rehoming facility was designed and manufactured several years ago, yet the facility maintains a modern and fresh feel. This is testament to the quality and finish of TECHNIK Projects.



CLAIRE HORTON
CEO Battersea Dogs & Cats Home



“TECHNIK have for several years designed and supplied materials for our dog kennels and cat pens. They helped us in the creation of state of the art new kennels that provide a comfortable, quiet and calm environment for the dogs that have just arrived in our care. Battersea takes in around 13 dogs every day and it is very important to us that we provide the very best kennel environment for dogs that will often be unsettled on their arrival. The workmanship on these kennels has been high quality, easy to maintain and clean”.





Battersea Dogs & Cats Home

TECHNIK worked closely with Jonathan Clark Architects to design and supply installations on two prestigious projects; a dog rehoming centre and a new build veterinary hospital with a centre of excellence. The projects were the biggest in the charity's 157 year history.



Adrian Burder
CEO of Dogs Trust



“We have worked with TECHNIK for many years and have always found them professional, reliable and a pleasure to work with”

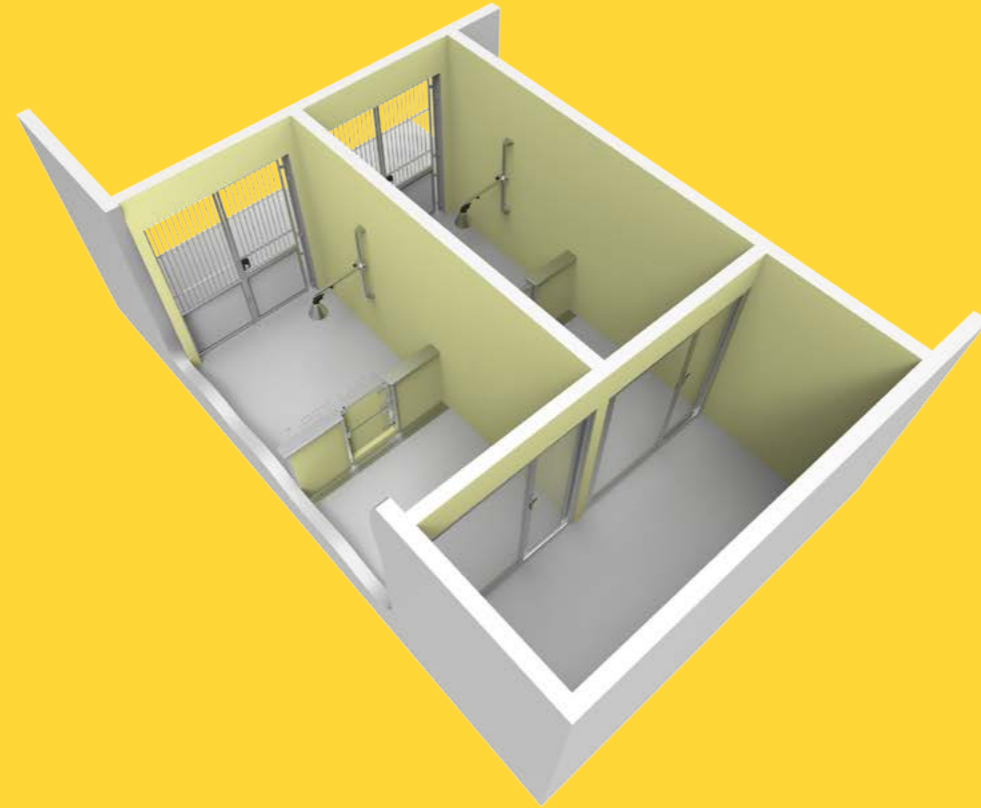

Puppy Rehoming and Viewing Area



Dogs Trust

Dogs Trust is the largest dog welfare charity in the UK, rehoming over 13,000 dogs per year. At TECHNIK we are pleased to be part of this success and believe that a well designed and manufactured centre is key to aiding this charity's work. To date, we have completed nine new Dogs Trust centres and some smaller project refurbishments throughout the British Isles.

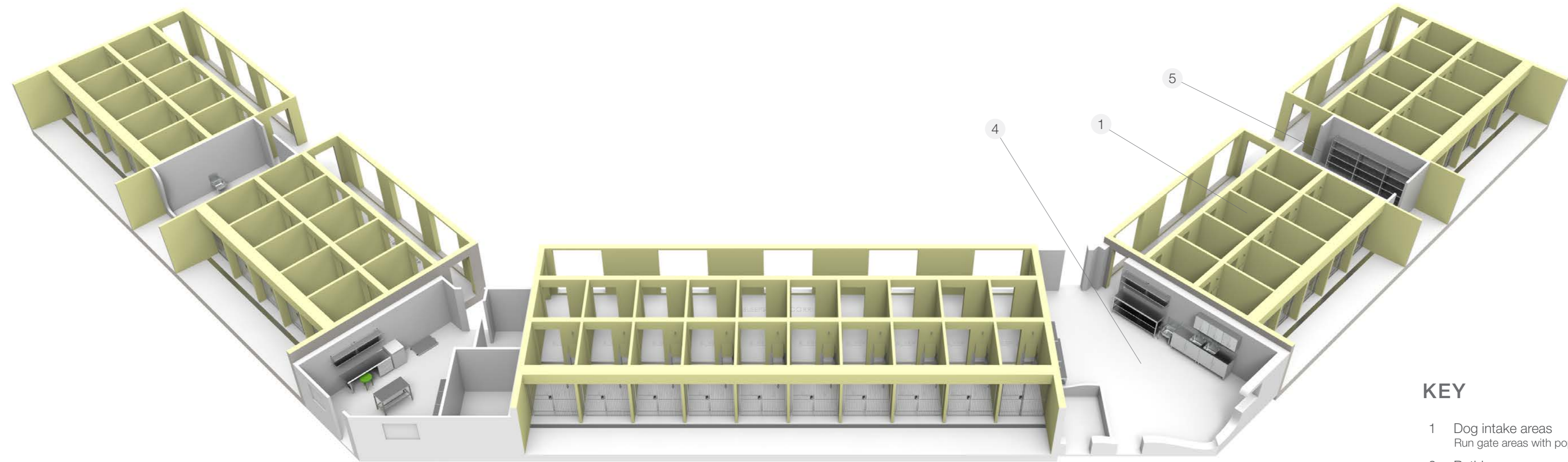

DOGS TRUST NEW INTAKE AREA

The intake area at Evesham has 3 banks of 10 run gate kennels with pop hatches. Separating the banks are rooms specified with hygienic stainless steel cabinetry and equipment, including the dog bathing area, vets consultation suite, food prep and laundry. The centre is designed with the welfare of animals, visitors and staff in mind. The intake runs and kennels are spacious and comfortable, a perfect start to the rehoming journey.



KEY

- 1 Dog intake areas
Run gate areas with pop hatches
- 2 Bathing area
Equipped with stainless steel essentials
- 3 Veterinary consultation
Examination tables, weigh scales etc...
- 4 Food preparation area
Stainless steel cabinetry and sinks
- 5 Laundry area
Aluminium racking and shelving

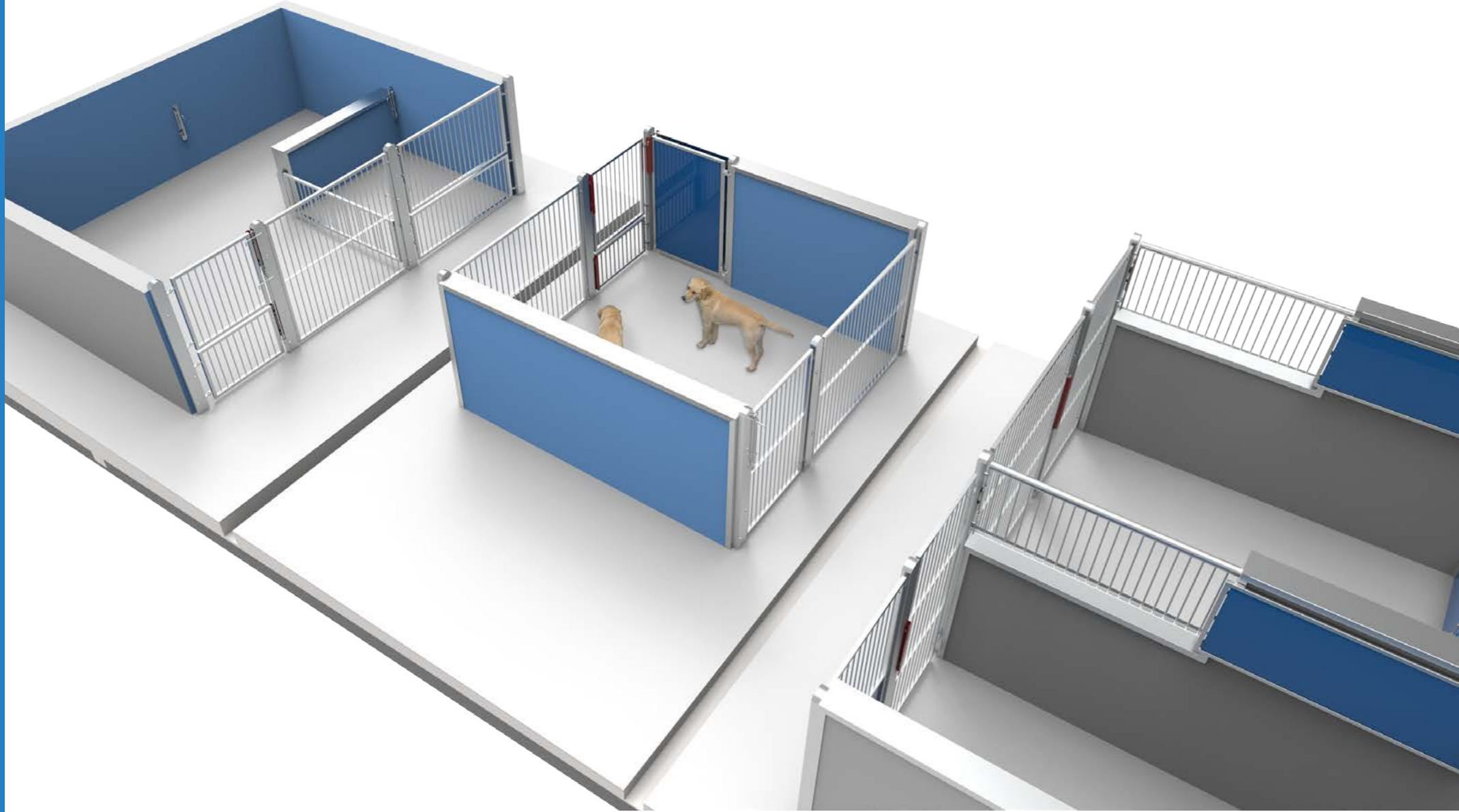

TRAINING FACILITIES



TECHNIK were commissioned to design and manufacture facilities for breeding and training centres in Leamington Spa, Forfar and Bolton. These environments are designed to ensure puppies and dogs are calm and confident. A place where concentration and learning can be successfully achieved. In the region of 1300 puppies are raised and begin their guide dog training annually, making hygiene and durability key project specifications.



Barehams

BOARDING FACILITIES

The boarding market is increasingly high spec as pet owners want their animals to have a 'home from home' experience.

TECHNIK's designs help to minimise the stress of being away from home. The high grade stainless steel and glass construction kennels are roomy and provide a safe, secure and happy environment for either single or family occupancy.

Barnewood Boarding kennels have 8 'home from home' kennels, comprising gardens, patios, sofas, 56 Channel TV and underfloor heating. The clinical grade construction ensures that the kennels are easy to keep spotlessly clean.

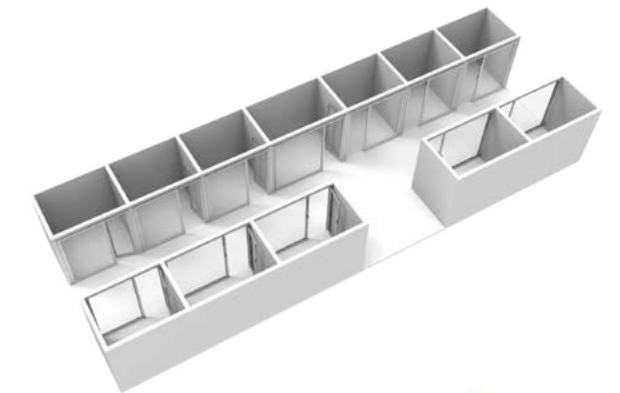

Mission Rabies

'Thanks to TECHNIK support, MR has vaccinated over 650,000 street dogs and rabies educated over 1.5million children over the last 3 years'

The MR programme was launched in the rabies hotspot of the world – India, where a third of all deaths are reported to occur. Working closely with the founder Luke Gamble, TECHNIK supplied and fitted out the mobile field hospital to be used for neutering and vaccinating dogs.



LUKE GAMBLE

Founder and CEO of Mission Rabies



“Seeing the fear this disease creates in local communities and the needless cruel deaths of thousands of dogs, I knew I had to do something. As veterinary professionals, this is our opportunity to really give something back. Rabies can be stopped and we have the know-how to do it - we just need you to join us and make Mission Rabies a success.”

Luke Gamble.

Pictured: Right, Luke Gamble getting the first operation underway.





TECHNIK were commissioned by the University of Bradford to design and manufacture the stainless steel cabinetry for a new Anatomy and Pathology Resource Centre. The project utilises clinical grade stainless steel for specimen drawers, storage cabinetry and computer cabinets.



The University College of Cork commissioned TECHNIK to provide precision equipment for a new anatomical training suite. The anatomical training tables are designed specifically for dissection and research. Engineered for medical use, 100% accuracy was a necessity in the design brief of these electronic tilting tables.



Veterinary service columns were installed at Fredrikstad in Norway. Service columns can be fitted within walls or positioned centrally from floor to ceiling. The columns at Fredrikstad are back to back for an economic use of space.

VETERINARY SERVICE COLUMNS

Veterinary service columns are height adjustable, ensuring patients can be positioned at a comfortable working height.

Advantages:

- Perform procedures at optimum working height
- Work with unrestricted movement around the patient
- Safe patient handling up to 100kg. The tables can lower to floor level for patient transfer
- Ease of cleaning around apparatus

Service columns can be specified with:

- Operating table
- Tub table
- Consultation table with in built weigh scale

SPECIFICS

Max load: 100 (kg)
 Column height: 2280 (mm)
 Column width: 600 (mm)
 Column depth: 230 (mm)
 Table width: 600 (mm)
 Table depth: 1300 (mm)
 Min loading height: 104 (mm)
 Min with tub table: 180 (mm)
 Max loading height: 1104 (mm)
 Max with tub table: 1180 (mm)





SMALLER SCALE SPECIALIST PROJECTS

Clients often require new installations to be integrated within an existing space. Smaller scale projects are often installed into businesses operating 365 days a year. At TECHNIK Projects we understand that minimal disruption to your day to day business is paramount.



Heathrow Animal Reception Centre is the live animal border inspection post for Heathrow Airport. TECHNIK Projects worked on replacing galvanised kennel doors with stainless steel single and double kennel doors. The heavy duty door construction included mesh panel, glass viewing panels and low level kick plates.



P&O accept dogs, cats and other small animals on board. TECHNIK Projects worked on a kennel bank to suit a variety of animal sizes. The mixed kennel bank also includes a storage facility. The kennel bank was specifically designed for separation to ensure animals cannot see each other in transit.

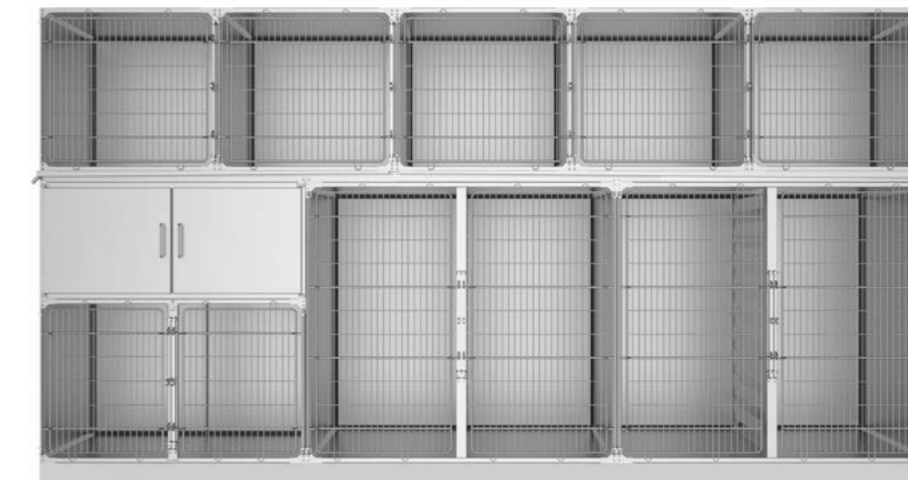

Carla Lane Animals In Need often has a capacity of 100 animals including dogs, cats, rodents, sheep and goats. The centre also has boarding kennels and a cattery.

Opposite is a smaller scale project which was integrated into an existing building where space constraints formed a crucial part of the design process.



VETERINARY RECOVERY ROOM

It is vital that the design and layout of recovery rooms are configured with care and provide excellent observation. TECHNIK fixtures are robust, hygienic and manufactured from clinical grade stainless steel with options for kennel and cat pen doors to be specified to suit.

KEY

- 1 Kennel banks
- 2 Stainless steel furniture
- 3 Hand hygiene sink
- 4 Janitor sink
- 5 Walk-in kennel with full cage door
- 6 Heat lamps

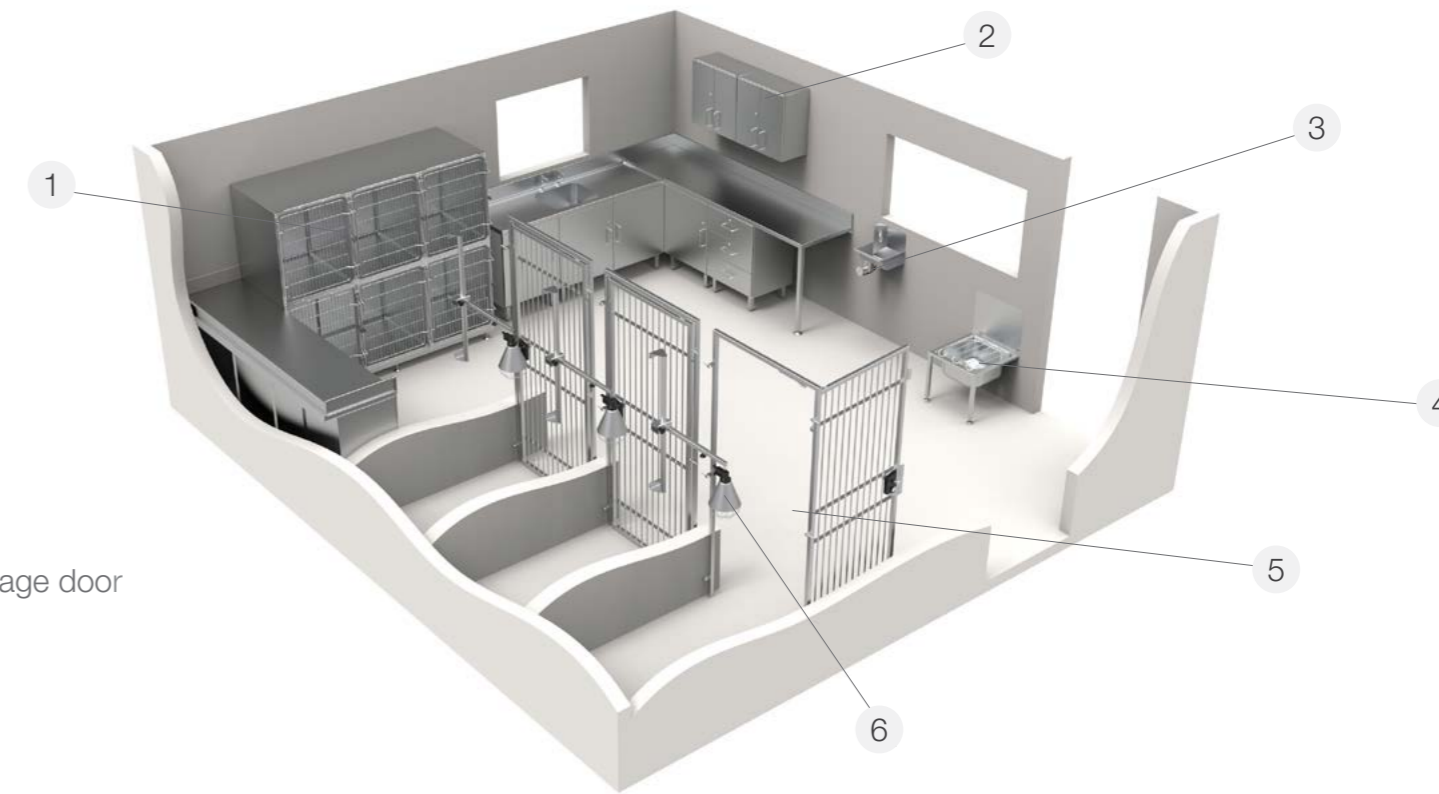

Walk-in kennel doors can be designed specifically to your requirements. From full glass, combination, full cage or critical care.



ANCILLARY AREAS

Made to measure stainless steel cabinetry, worktop and sink areas are ergonomically designed and maximise space. They are easy to clean for busy hygiene conscious areas. We supply storage racking and shelving in stainless steel or lighter weight aluminium for utility storage.

Waterproof Construction Board Closed Cell Cat Pens

Easily cleanable, coated in additional Biomaster antibacterial technology. Using this material ensures TECHNIK are able to offer modern, ultra-hygienic, long lasting cat pens ideal for any veterinary practice or cat shelter.



Electric Lift Table

This fully mobile electric lift table provides a hygienic and durable solution to moving and transferring patients. The electric lift mechanism reduces the risk of staff injury, perfect for lifting larger patients without unnecessary handling and movement. It is available as standard, with weighscale or with a tub table.



Sinks With Dyson Airblade Tap Hand Dryer

This sink is incredibly hygienic. The Airblade Tap Hand Dryer has a HEPA filter which captures 99.95% of bacteria. Hands are washed and dried (12 sec drying time) within the sink area.



dyson airblade tap

SOME ESSENTIAL PRODUCTS

TECHNIK supply and manufacture a wide range of products to compliment projects.

THE TECHNIK PROJECT PROCESS

'We can interpret design and apply the best engineering and manufacturing processes to your ideas.'



'The job of our team is to facilitate the fabrication of your project, from initial plans to executing installation. We are fortunate to have worked alongside many great architects and project managers to bring installations to fruition'

The Team at TECHNIK Veterinary and Animal Charities Division



WORKING WITHIN ARCHITECTURE

Working partnerships are key to the success of any project. TECHNIK believe that our culture of effective communication and information sharing aids in achieving a successful outcome.

Our team work with all CAD software and architectural packages

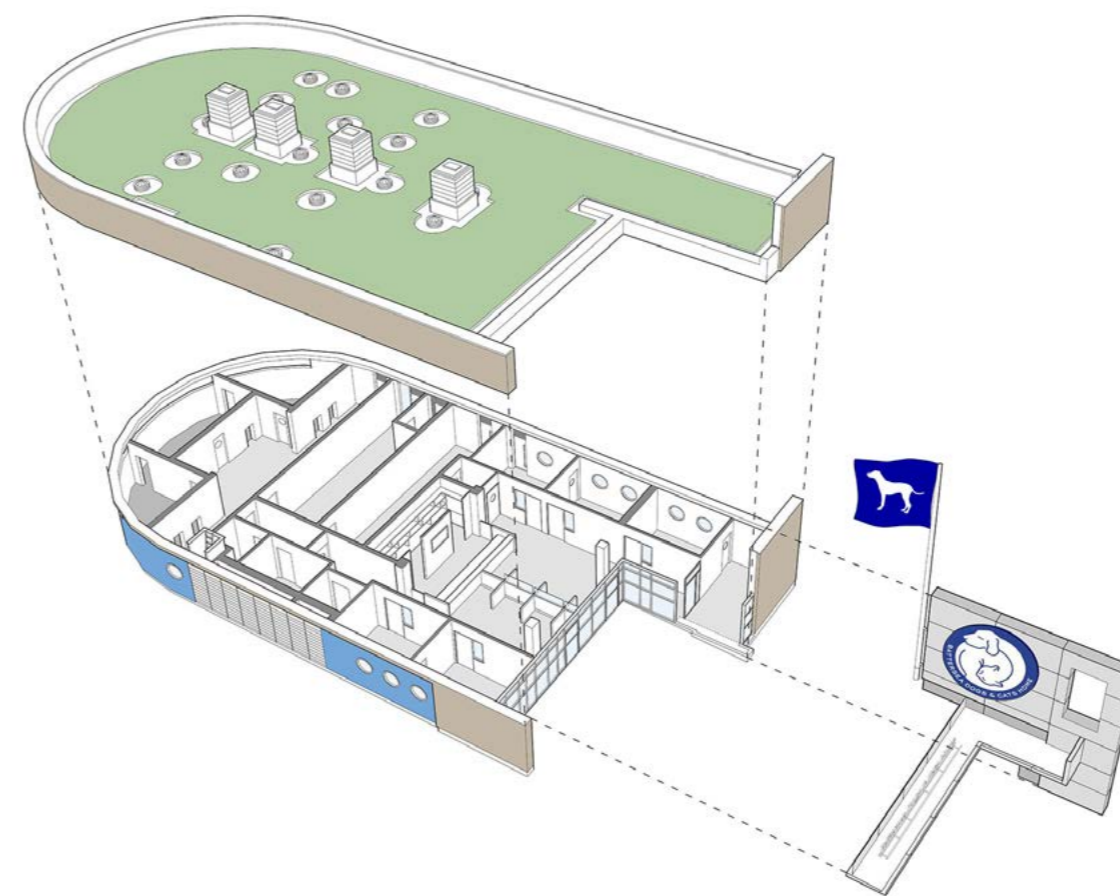



REHOMING BUILDINGS

TECHNIK Projects provide the highest standards of care and welfare for dogs in this rehoming building example. Designed to have comfortable and cosy sleeping areas and a quiet, relaxed environment for prospective adopters to view their potential new companions. A state of the art project, offering the very best environment for dogs while they await to be rehomed.



KEY

- 1 Spacious stainless steel framed glass doors
Allowing good visibility and for the dog to feel secure
- 2 Run area
A large space for feeding and quiet time
- 3 Pop hatch
Counter balanced opening for ease of use

Sponsored Kennels
Oversized kennels for dogs that are long term residents



OPTIONS

1 Run Gates

Standard

* Standard Inc Counterbalance

2 Pop Hatches

Manual Lift

Without Flap

Counterbalance

3 Drains

Maximum 5m Length

4 Glazed Fronts

Standard

* Standard Inc Counterbalance

5 Kennel Dividers

Stainless Steel

Glass

Sliding Door

Construction details a solid wall, however dividers can be specified.

* The counterbalance operates the pop hatch from either the run gate or the glazed front.

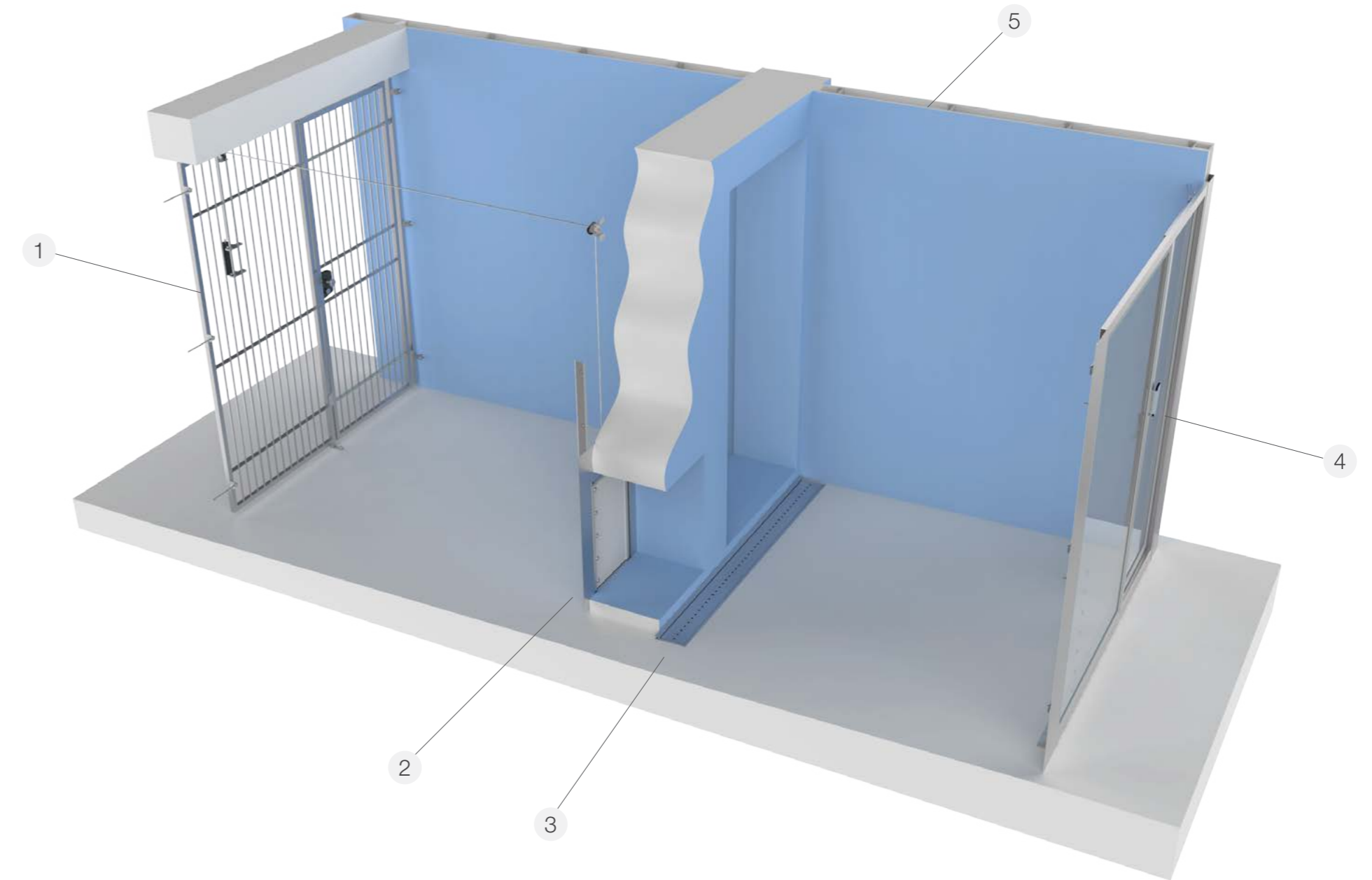

CUSTOM BUILDING

Boarding and rehoming modules can be customised with the options detailed within this diagram to suit exact requirements.

THE ASSEMBLY PROCESS

1st Fix

Shows the drain and divider support frames fitted to the slab and rear wall of the building.

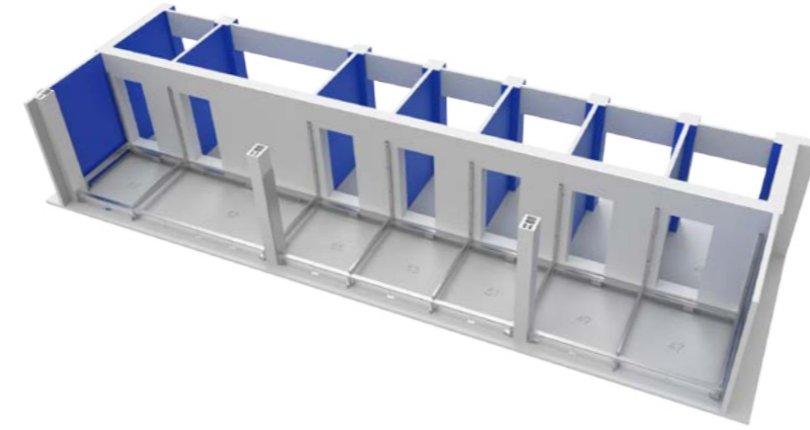

2nd Fix

Underfloor heating and screed are applied. Followed by dividing walls, kennel front frames, pop hatch frames and door frames, between the run and sleeping sections.

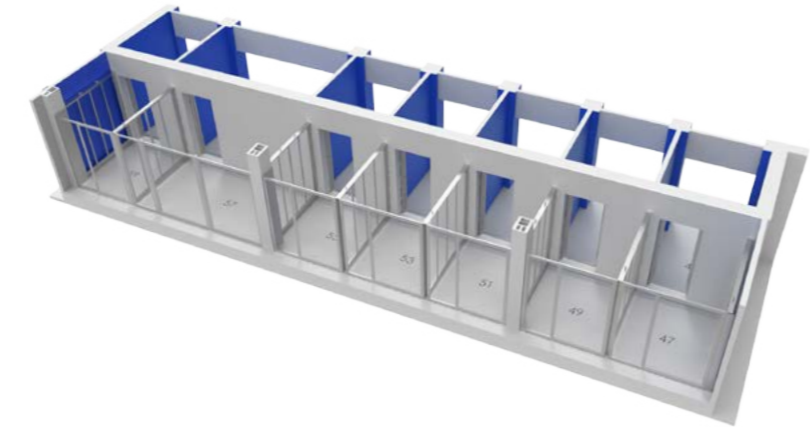

3rd Fix

After the ceiling has been fitted by the contractor, dividing frames are glazed with ceramic coated glass. The fronts are glazed with clear glass and door assemblies fitted. Finally, the run gates and pop hatch doors are installed.

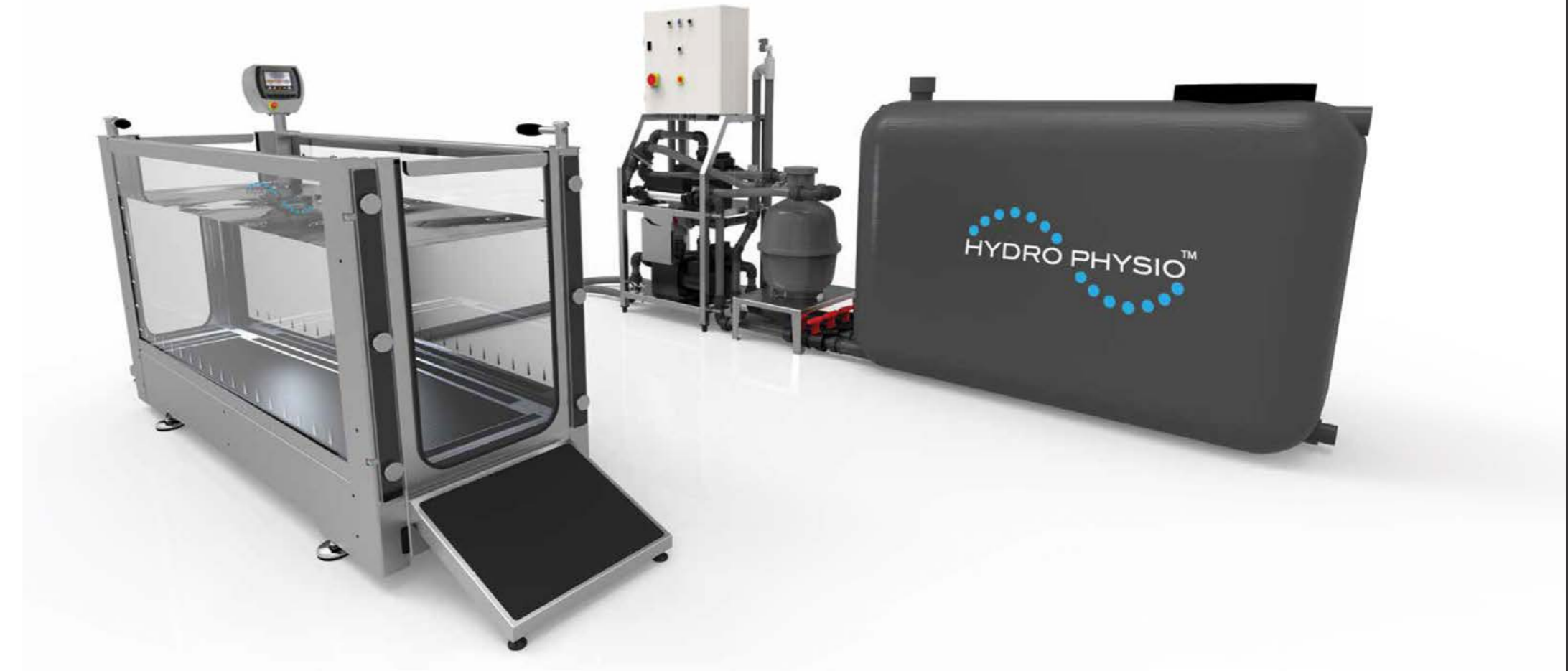
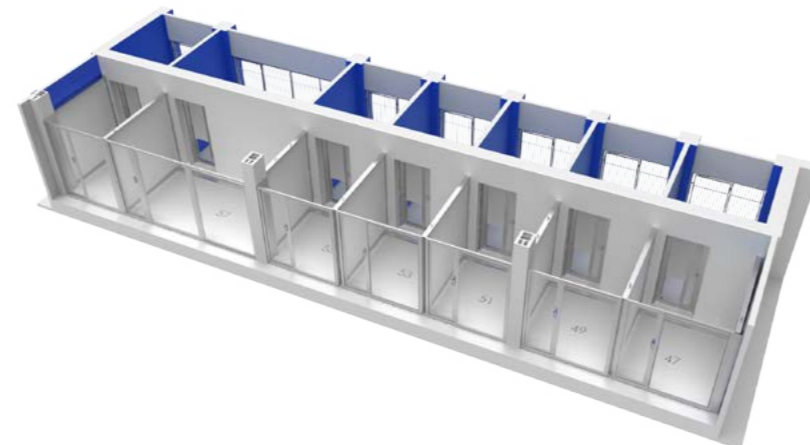

Rehabilitation • Balance and Stability • Circulation • Psychological Wellbeing • Pain Management • Gait and Posture

Rehoming centres often receive animals in poor condition with a variety of treatable issues. TECHNIK is a sister company division to HYDRO PHYSIO, a market leader in canine hydrotherapy treadmills and the first choice for rehabilitation facilities worldwide.

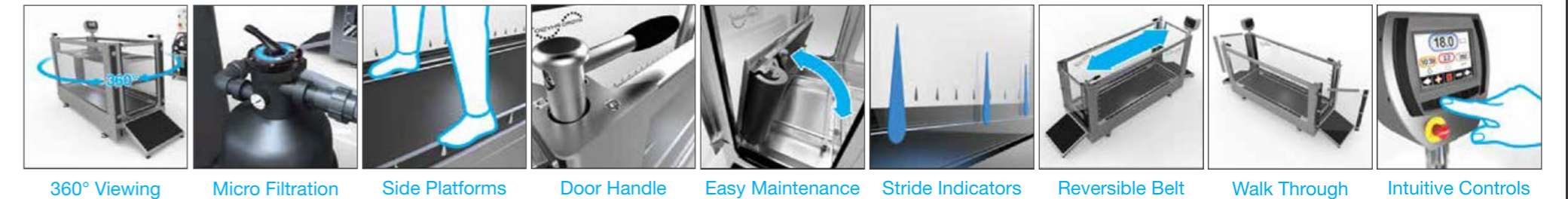

360° Viewing • Micro Filtration • Side Platforms • Door Handle • Easy Maintenance • Stride Indicators • Reversible Belt • Walk Through • Intuitive Controls



TECHNIK™ PROJECTS

'TECHNIK and its associated company divisions have over 40 years of expertise in the manufacture of stainless steel and aluminium products. A highly skilled team, who work closely with architects, designers and developers to deliver high quality products and projects.'

ASSOCIATED COMPANY DIVISIONS

SYSPAL™

The UK's leading manufacturer of stainless steel equipment for hygiene conscious industries. Amongst the most advanced manufacturing facilities in the world. SYSPAL's products are designed considering best practice.



MANiFAB™

Working on anything from small custom components to large-scale bespoke projects MANiFAB are able to call upon a design team with a wealth of experience to work closely with clients to transform concepts into realities.



HYDRO PHYSIO are the market leading manufacturer of both canine and human hydrotherapy treadmills. These canine treadmills are the market leader and the first choice for veterinary surgeries and rehabilitation facilities worldwide.



TECHNIK™ PROJECTS



A SELECTION OF ORGANISATIONS
WE ARE PROUD TO HAVE WORKED WITH



EDUCATIONAL ESTABLISHMENTS
WE ARE PROUD TO HAVE WORKED WITH

EXHIBITIONS AND CONFERENCES
WE ATTEND AND SUPPORT

TECHNIK Projects
Broseley
Telford
Shropshire
TF12 5JA

✉ sales@technik-veterinary.com

🌐 www.technik-veterinary.com

☎ +44 (0)1952 885555



FM 25162 MD 516639

